

## INSPECTION

### 1. INSPECT POWER QUARTER WINDOW SWITCH CONTINUITY

Switch position	Tester connection	Specified condition
CLOSE	3 - 6 4 - 5	Continuity
OFF	-	Continuity
OPEN	3 - 4 5 - 6	Continuity
Illumination Circuit	1 - 2	Continuity

If continuity is not as specified, replace the switch.

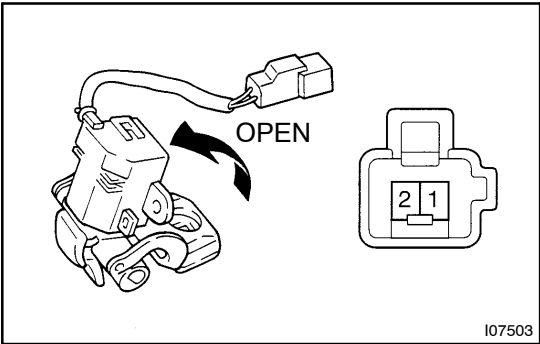

### 2. Left side: INSPECT POWER VENT WINDOW MOTOR OPERATION

- (a) Connect the positive (+) lead from the battery to terminal 1 and the negative (-) lead to terminal 2, and check that the window link moves to OPEN position.

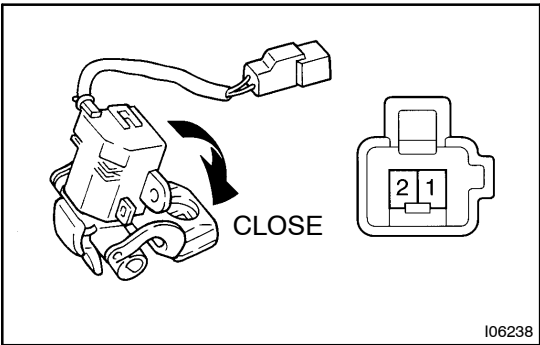

- (b) Remove the polarity and check that the window link moves to CLOSE position.

If operation is not as specified, replace the window motor.

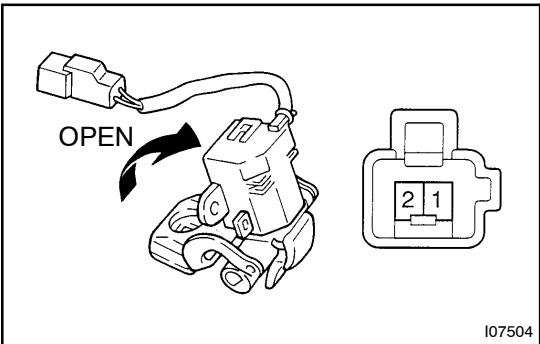

### 3. Right side: INSPECT POWER VENT WINDOW MOTOR OPERATION

- (a) Connect the positive (+) lead from the battery to terminal 2 and the negative (-) lead to terminal 1, and check that the window link moves to OPEN position.

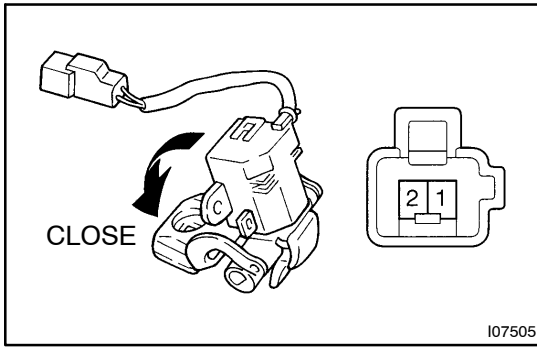

- (b) Remove the polarity and check that the window link moves to CLOSE position.